

INSTALLATION AND OPERATING INSTRUCTIONS

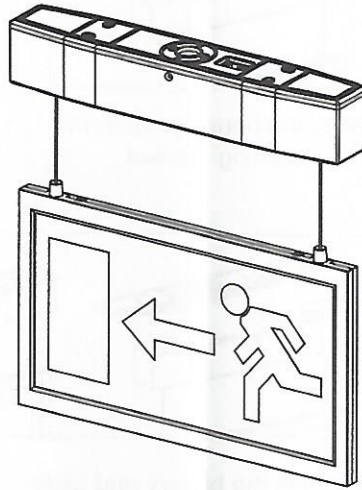

MAINS POWERED BATTERY BACK UP EXIT SIGN

EN 60598-1

EN 61000-3-2

EN 62031

EN 61347-1

EN 60598-2-22

EN 61000-3-3

EN 62471

EN 61347-2-13



GENERAL INFORMATION

This product is a fully self contained illuminated exit sign. It has an inbuilt battery, battery charger, controller and test button. The LED light source provides low power consumption and long life. The acrylic panel is printed with a dot matrix lens effect pattern and overlaid with a polypropylene diffuser to provide high brilliance and even illumination over the full surface of the sign.

TECHNICAL DATA

Power Supply	: 220-240VAC, 50 Hz
Power Consumption	: Max. 4W
Maximum Surface Temp	: 35°C
Ambient operating Temp	: 0°C-25°C
Panel	: Acrylic board with imprinted dot matrix lens diffusion

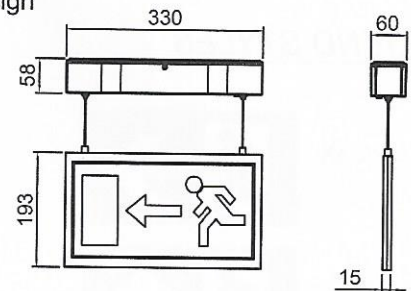

PRECAUTIONS

This product should be installed by a registered electrician in accordance with local standards and electrical regulations. Take care to ensure the mains supply is isolated before installation. Check the unit label for correct supply voltage and frequency.

SERVICE & OPERATION

Normal Operation: The green indicator light on the side of the unit stays on. The LED will go out if the mains supply fails, if the internal charger malfunctions, or if the unit is in test mode.

Battery: Sealed Ni-Cad & Ni-Mh rechargeable battery pack. Batteries of a different type must not be used. Batteries should be replaced by authorized service personnel only. If the unit no longer maintains its rated battery backup test times, it should only be replaced by competent service personnel with the manufacturer's battery pack. Old batteries should be recycled.

Test Switch: If pressed, the unit LED indicator light will go out and the sign will operate from its battery supply.

INSTALLATION

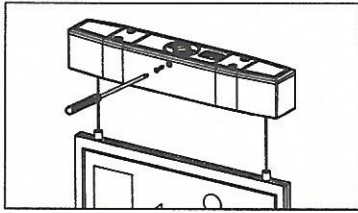

- ① Remove fixing screw from the housing

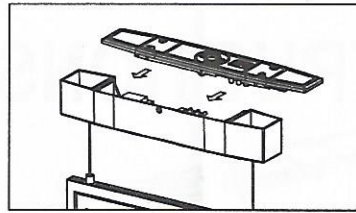

- ② Slide the housing out from the mounting bracket

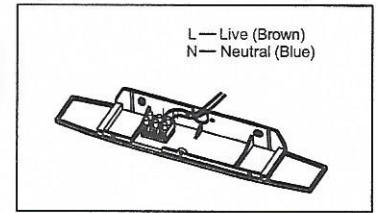

- ③ Feed the power cable through the knock out hole and connect to terminal block

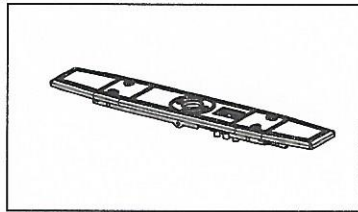

- ④ Secure mounting bracket to wall or ceiling

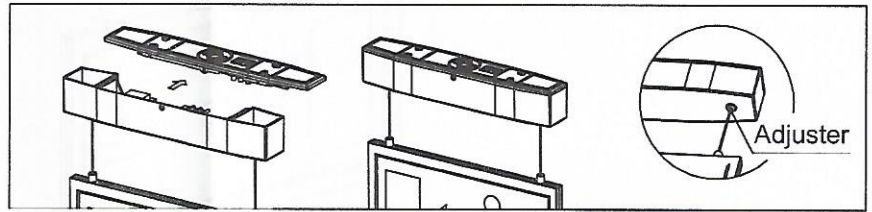

- ⑤ Connect the battery and Slide housing on to mounting bracket and screw in place

- ⑥ Push adjuster release and set length of suspension wire

MOUNTING OPTIONS

Wall surface mount



Ceiling mount

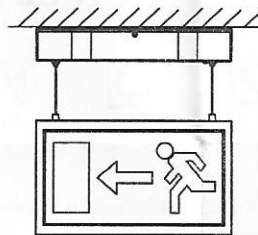

Side mount

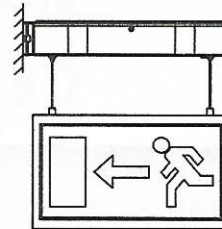

LEGEND STYLES

LUPG3X



Maintained and Non maintained operation:

Jumper cable

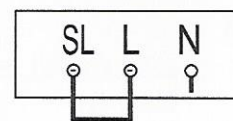

Maintained operation:

Connect L,N and leave jumper cable connected.

Non-Maintained operation:

Connect L,N and remove jumper cable .

TECHNICAL INFORMATION

Model Number	Input Voltage	Charge Duration	Discharge Duration	Battery	Power	LED	Viewing Distance	Lumen output after discharge duration
LL-05-MBD089-001B	220-240V~50Hz	24h	3 h	Ni-MH,3.6V 1000mA Ni-Cd,3.6V 1000mA	4W	SMD3528, white 14pcs	30M	8.47 lm

INSTRUCTIONS FOR AUTOMATIC TEST OPTION

(EXIT LIGHT SELF DIAGNOSTICS/SELF TEST FUNCTION)

1. Install LED exit sign according to installation instruction sheet
2. Once the unit is powered up it will automatically initiate a self test and diagnostics as follows:

- Every 4 seconds : Checks for battery disconnection, charger board fault, lamp failure and transformer failure
- Every month : Performs a 3 minute duration test
- Every year : Performs a 1 Hour or 3 Hour duration test

All test functions are factory preset and do not need field adjustment

3. Dual Colour Indicator LED Status Meanings

- Green Solid On Ready / Normal Operation
 Flashing Testing
- Red Requires Service

•	One flash, 4 second pause	Battery not connected
••	Two flashes, 4 second pause	Battery short or low battery voltage
•••	Three flashes, 4 second pause	Charger board fault
••••	Four flashes, 4 second pause	Transformer fault
•••••	Five flashes, 4 second pause	LED lamp fault

NOTE

After repairing a service fault, press and hold the test button for 2 seconds to reset the flashing indicator light to green

4. Manual Testing

Press test button once	30 second duration test
Press test button twice within 2 seconds	3 minute duration test
Press test button 3 times within 2 seconds	30 minutes duration test
Press test button 4 times within 2 seconds	1 or 3 hours duration test